

Short date stamp
 Fechador anual corto
 Datownik krótki
 Datador anual curto

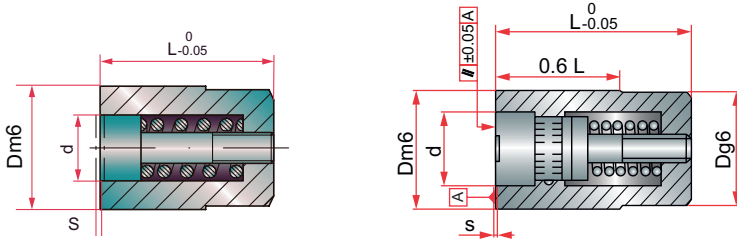

Only D: 4Ø

Blank/S

DA/S

DF/S

DM/S

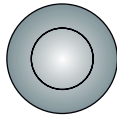

6 years



Mat. : INOX. 1.4034. Hardness: 51 ± 3 HRC. Maximum temperature at work: 150° C.

s	d	D	L	REF.	
0,20	2,2	4	5	Blank/ 4S	
				DA/ 4S	
				DF/ 4S	
				DM/ 4S	
0	2,9	5	8	Blank/ 5S	
				DA/ 5S	
				DF/ 5S	
				DM/ 5S	
	3,7	6			Blank/ 6S
					DA/ 6S
					DF/ 6S
					DM/ 6S
5	8	8	10	Blank/ 8S	
				DA/ 8S	
				DF/ 8S	
				DM/ 8S	

s	d	D	L	REF.
0	6,3	10	12	Blank/ 10S
				DA/ 10S
				DF/ 10S
				DM/ 10S
	7,5	12	14	Blank/ 12S
				DA/ 12S
				DF/ 12S
				DM/ 12S
	8,7	16	20	Blank/ 16S
				DA/ 16S
				DF/ 16S
				DM/ 16S
	10,7	20		Blank/ 20S
				DA/ 20S
				DF/ 20S
				DM/ 20S

IMPORTANT

Special engraving available under request.
 Grabados especiales bajo demanda.

Long date stamp
 Fechador anual largo
 Datownik długi
 Datador anual longo

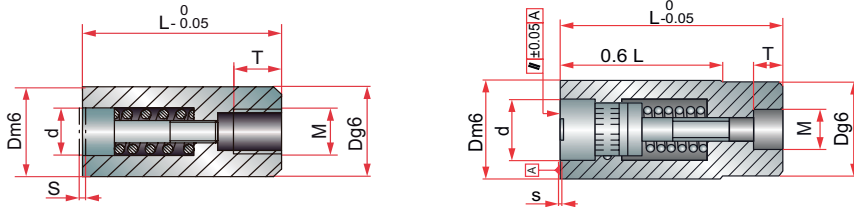

Only D: 40

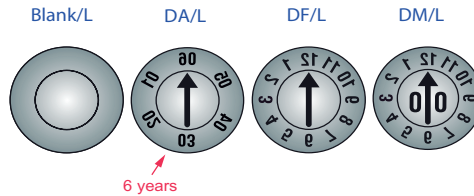

Mat. : INOX. 1.4034. Hardness: 51 ± 3 HRC. Maximum temperature at work: 150° C.

s	T	M	d	D	L	REF.		
0,2	3,5	M2	2,2	4	12	Blank/ 4L		
						DA/ 4L		
						DF/ 4L		
						DM/ 4L		
0		M3	2,9	5		Blank/ 5L		
						DA/ 5L		
						DF/ 5L		
						DM/ 5L		
					3,7	6	20	Blank/ 6L
								DA/ 6L
								DF/ 6L
								DM/ 6L

s	T	M	d	D	L	REF.		
0	4	M4	5	8	20	Blank/ 8L		
						DA/ 8L		
						DF/ 8L		
						DM/ 8L		
						Blank/ 10L		
		M5	6,3	10		DA/ 10L		
						DF/ 10L		
						DM/ 10L		
				M6	7,5	12		Blank/ 12L
								DA/ 12L
								DF/ 12L
								DM/ 12L

IMPORTANT Special engraving available under request.
 Grabados especiales bajo demanda.

Double date stamp
 Fechador doble
 Datownik podwójny
 Datador duplo

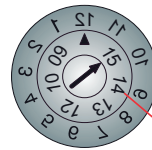
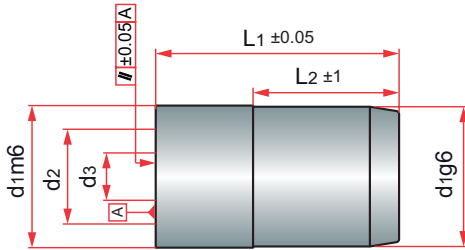

12 Months + Years
 N° of years
 N° años
 Liczba lat
 N° de anos

Mat. : INOX. 1.4034. Hardness: 51 ± 3 HRC. Maximum temperature at work: 150° C.

N	L ₂	d ₃	d ₂	d ₁	L ₁	REF.
6	5	2,5	5	8	20	DD/ 8
		3	6	10		DD/ 10
		4	8	12		DD/ 12
		5	10	16		DD/ 16

IMPORTANT

Special engraving available under request.
 Grabados especiales bajo demanda.

Date insert
 Indicador anual
 Wkładka datownika
 Inserto anual



Only: 2,2 Ø

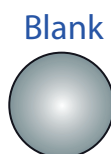
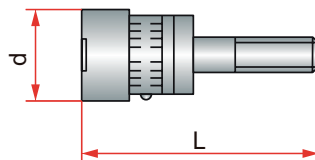
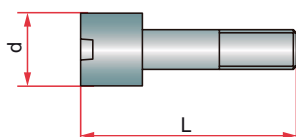

Mat. : INOX. 1.4034. Hardness: 51 ± 3 HRC. Maximum temperature at work: 150° C.

D	L	d	REF.
4	5	2,2	IA/ 4 + YEAR
			IF/ 4
			BLANK/ 4
5	8	2,9	IA/ 5 + YEAR
			IF/ 5
			BLANK/ 5
6		3,7	IA/ 6 + YEAR
			IF/ 6
			BLANK/ 6
8	10	5	IA/ 8 + YEAR
			IF/ 8
			BLANK/ 8

D	L	d	REF.
10	12	6,3	IA/ 10 + YEAR
			IF/ 10
			BLANK/ 10
12	14	7,5	IA/ 12 + YEAR
			IF/ 12
			BLANK/ 12
16	20	8,7	IA/ 16 + YEAR
			IF/ 16
			BLANK/ 16
20		10,7	IA/ 20 + YEAR
			IF/ 20
			BLANK/ 20

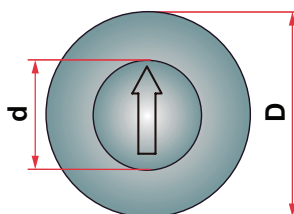

Reference insert
 Inserto referencia
 Wkładka znakownika recyklingu
 Indicadores de reciclagem

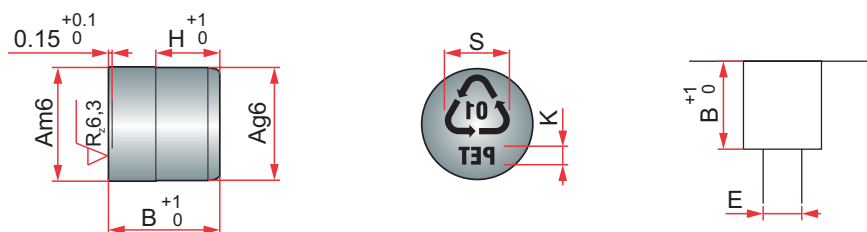

Mat. : INOX. 1.4034. Hardness: 51 ± 3 HRC. Maximum temperature at work: 150° C.

S	K	E	H	A	B	REF.
5,60	1,50	8	7	10	12	IR/ 1012
6,80	1,80	10		12		IR/ 1212
9,00	2,40	12	9	16	16	IR/ 1616
11,50	3,20	16		20		IR/ 2016

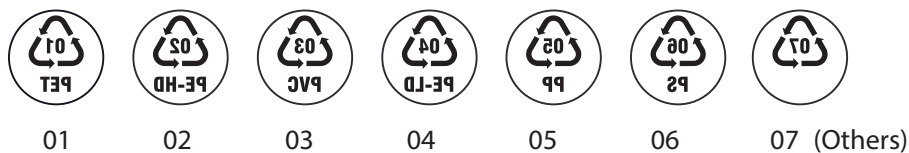

Indicate the desired model after the reference.
 Indiquer le sigle demandé après la référence.
 Indicar o modelo desejado depois da referência.
 Indicar el modelo deseado después de la referencia.

Short date stamp
 Fechador anual corto
 Datownik krótki
 Datador anual curto

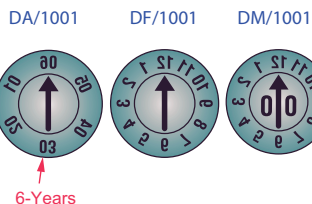
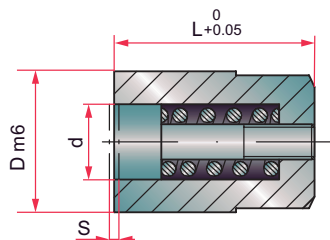

Mat. : INOX. 1.4034. Hardness: 56 ± 2 HRC. Stainless.

D	d	K	L	S	REF.
4	2,1	2,6	5	0,25	BR1301/ 4/ DA
					BR1301/ 4/ DF
					BR1301/ 4/DM
5	3,1	3,2	8	0,2	BR1301/ 5/ DA
					BR1301/ 5/ DF
					BR1301/ 5/DM
6	3,1	3,2	8	0,2	BR1301/ 6/ DA
					BR1301/ 6/ DF
					BR1301/ 6/DM
8	4,4	5,2	10	0,25	BR1301/ 8/ DA
					BR1301/ 8/ DF
					BR1301/ 8/DM
10	5,2	6,2	12	0,35	BR1301/10/ DA
					BR1301/10/ DF
					BR1301/10/DM
12	6,2	7,2	14	0,35	BR1301/12/ DA
					BR1301/12/ DF
					BR1301/12/DM
16	8,2	8,2	16	0,35	BR1301/16/ DA
					BR1301/16/ DF
					BR1301/16/DM

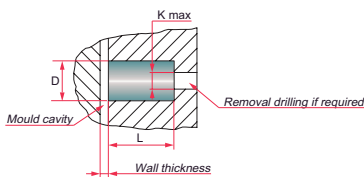

BR1302



Date insert
 Indicador anual
 Wkładka datownika
 Inserto anual

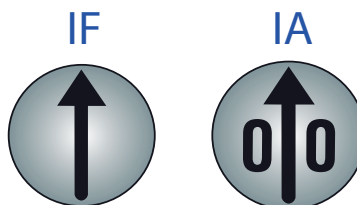
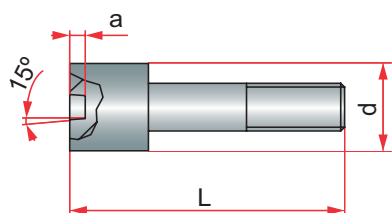

Mat. : INOX. 1.4034. Hardness: 56 ± 2 HRC. Stainless.

D	d	L	a	REF.
4	2,1	4,8	0,3	BR1302/ 4/IF
				BR1302/ 4/IA
5	3,1	7,8	0,4	BR1302/ 5/IF
				BR1302/ 5/IA
6	4,4	9,8	0,6	BR1302/ 6/IF
				BR1302/ 6/IA
8	5,2	11,8	0,6	BR1302/ 8/IF
				BR1302/ 8/IA
10	6,2	13,8	0,6	BR1302/10/IF
				BR1302/10/IA
12	8,2	16,8	0,6	BR1302/12/IF
				BR1302/12/IA
16	10,2	21,8	0,6	BR1302/16/IF
				BR1302/16/IA

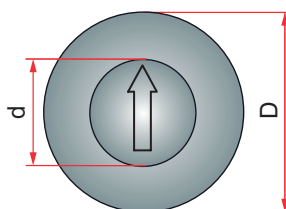

Long date stamp
 Fechador anual largo
 Datownik długi
 Datador anual longo

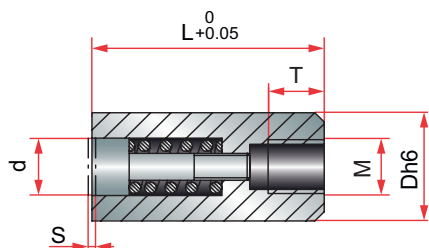

DA/1001

DF/1001

DM/1001

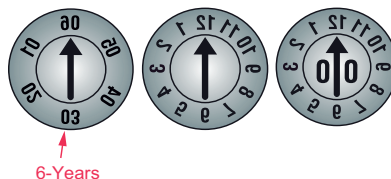

Mat. : INOX. 1.4034. Hardness: 56 ± 2 HRC. Stainless.

D	d	M	T	L	S	REF.
4	2,5	2	3	14	0,3	BR1001 / 4 / DF
						BR1001 / 4 / DA
						BR1001 / 4 / DM
5	3,1	3		17	0,4	BR1001 / 5 / DF
						BR1001 / 5 / DA
						BR1001 / 5 / DM
6						BR1001 / 6 / DF
						BR1001 / 6 / DA
						BR1001 / 6 / DM
8	4,6	4	4	20		BR1001 / 8 / DF
						BR1001 / 8 / DA
						BR1001 / 8 / DM
10		5				BR1001 / 10 / DF
						BR1001 / 10 / DA
						BR1001 / 10 / DM
12	6,4	6	6	25	0,6	BR1001 / 12 / DF
						BR1001 / 12 / DA
						BR1001 / 12 / DM
16	8,4	8	8	33		BR1001 / 16 / DF
						BR1001 / 16 / DA
						BR1001 / 16 / DM

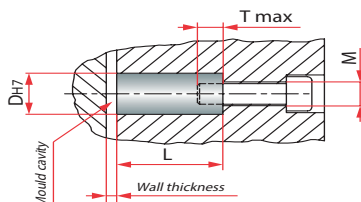

BR1002



Date insert
 Indicador anual
 Wkładka datownika
 Inserto anual

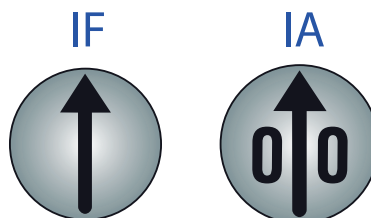
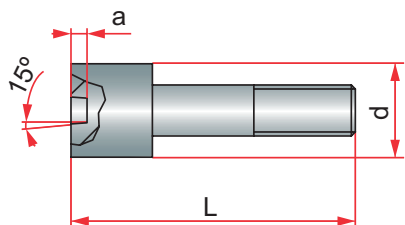

Mat. : INOX. 1.4034. Hardness: 56 ± 2 HRC. Stainless.

D	d	L	a	REF.
4	2,5	10,5	0,3	BR1002/ 4/IF
				BR1002/ 4/IA
5	3,1	13	0,4	BR1002/ 5/IF
				BR1002/ 5/IA
6	4,6	14	0,6	BR1002/ 6/IF
				BR1002/ 6/IA
8	8,4	23	0,6	BR1002/ 8/IF
				BR1002/ 8/IA
10	10,5	10,5	0,3	BR1002/10/IF
				BR1002/10/IA
12	12,7	17	0,6	BR1002/12/IF
				BR1002/12/IA
16	16,0	23	0,6	BR1002/16/IF
				BR1002/16/IA

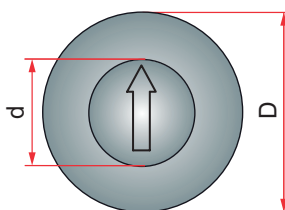

BR111



Cycle counter
 Contador de ciclos
 Licznik cykli
 Contador de ciclos

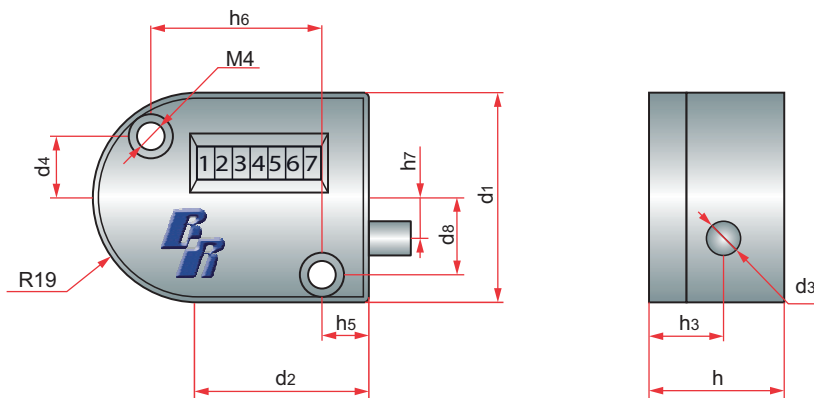

Maximum temperature at work: 120° C.

d_2	d_4	d_3	h_3	h_5	h_7	h_6	d_3	d_1	h	REF.
31	11	14	13,4	8,5	7,5	31	6,2	38	24,5	BR111/

